

PORCELAIN INSULATORS

- Low, medium and high voltage insulators
- Transformer bushing insulators
- Line insulators
- For outdoor and indoor use



**IRAN TRANSFO
CORPORATION**

www.iran-transfo.com

WE EARN CUSTOMER SATISFACTION

Document No.:
CI0090-Rev0.2005



Table of content

معرفی:	۳
Introduction:	3
فرآیند تولید:	۴-۵
Production process:	4-5
آزمایشگاه فشار قوی:	۵-۶
High voltage laboratory:	5-6
آزمایشگاه فیزیک سرامیک:	۶
Ceramic physical laboratory:	6
محصولات:	۷-۱۴
Our products:	7-14

IRAN TRANSFO CORPORATION

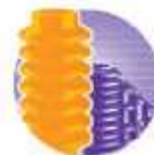

شرکت مقره سازی صدف گستر زنجان

Zanzan Sadaf Gostar Insulator Co.

Introduction

Zanzan Sadaf Gostar Insulator Co. founded in 2000, has become one of the leading producers of porcelain insulators in Iran. We offer a wide range of products including low, medium and high voltage insulators.

Insulators presented in this catalogue are standardized products meeting requirements of domestic, foreign and international standards. The company is certified by **ISO 9001:2000** from SGS-Switzerland.

Our company is prepared for immediate commencement of production of new products according to customer's specifications.

Our company success in producing the high quality insulators is due to the customer's support and the local raw materials suppliers.



معرفی

شرکت مقره سازی صدف گستر زنجان در سال ۱۳۷۹ تأسیس شد و هم اکنون به یکی از تولید کنندگان برجسته مقره های پوسلانی در ایران تبدیل شده است. این شرکت محدوده وسیعی از محصولات شامل انواع مقره های ولتاژ پایین، متوسط و قوی را عرضه میکند. مقره هایی که در این کاتالوگ معرفی شده اند، محصولات استاندارد هستند که تمامی نیازهای استانداردهای داخلی، خارجی و بین المللی را برآورده می سازند. شرکت مقره سازی صدف گستر زنجان دارای گواهینامه استاندارد **ISO 9001:2000** از **SGS** سوئیس می باشد. شرکت ما آمادگی آفر به تولید محصولات جدید را با توجه به مشخصات مشتریان و در کوتاهترین زمان ممکن دارا می باشد. شرکت مقره سازی صدف گستر زنجان، موفقیت خود را در تولید مقره هایی با کیفیت عالی، مقرون حمایت بی وقفه مشتریان و تأمین کنندگان مواد اولیه داخلی می داند.



Production Process

فرآیند تولید

Raw materials	مواد اولیه
Weighing	وزن کشی
Milling	آسیاب کردن
Mixing	مخلوط کردن
Filter pressing	فیلتر پرس کردن
Ageing	برورش دادن
De-airing extruder	اکستروود خلاء
Profile turning	تراش دادن
Drying	خشک کردن
Glazing	لغاب زنی
Firing	پخت
Dimensions and shape controlling	کنترل ابعادی و شکل
Assembling	مونتاژ کردن
Electrical test	تست الکتریکی
Storage	انبار کردن
Shipment	توزیع



Profile turning

تراش دادن



Milling & Filter pressing

آسیاب کردن و فیلتر پرس کردن



Glazing

لغاب زنی



De-airing extruder

اکسترودر کردن



Firing

پخت



Firing

پخت

ازمایشگاه فشار قوی

شرکت مقوم ساری صدف گستر زنجان با تجهیز آزمایشگاه فشار قوی به تجهیزات مورد نیاز کلیه آزمایشات Routing & Sample را مطابق استانداردهای بین المللی جهانی ANSI, IEC, DIN و با هدف جلب رضایت مشتری و اطمینان از کیفیت مطلوب محصولات خود به انجام می رساند.

همچنین این شرکت، تحقیقات و توسعه درموارد سرامیک را بر مبنای فناوری خود دنبال می کند. در آزمایشگاه فشار قوی این شرکت آزمایشات زیر بر روی مقرها انجام می شود:

High Voltage Laboratory

Aiming at attracting the customer satisfaction and assuring the desired product quality, Zanjan Sadaf Gostar Insulator Co. performs all the Sample and Routing tests according to the international global standards IEC, DIN & ANSI.

This company also follows the research and development of ceramics cases according to it's technology. The following tests are performed on the insulators in the high voltage lab:

Sample test

Porosity test

تست تخلخل

Temperature cycle test

تست سیکل حرارتی

Mechanical test

تست مکانیکی

Mechanical-Electrical test

تست الکترومکانیکی

Verification of dimensions

تایید ابعادی

Routine test

Electrical test

تست الکتریکی

Visual examination

کنترل ظاهری

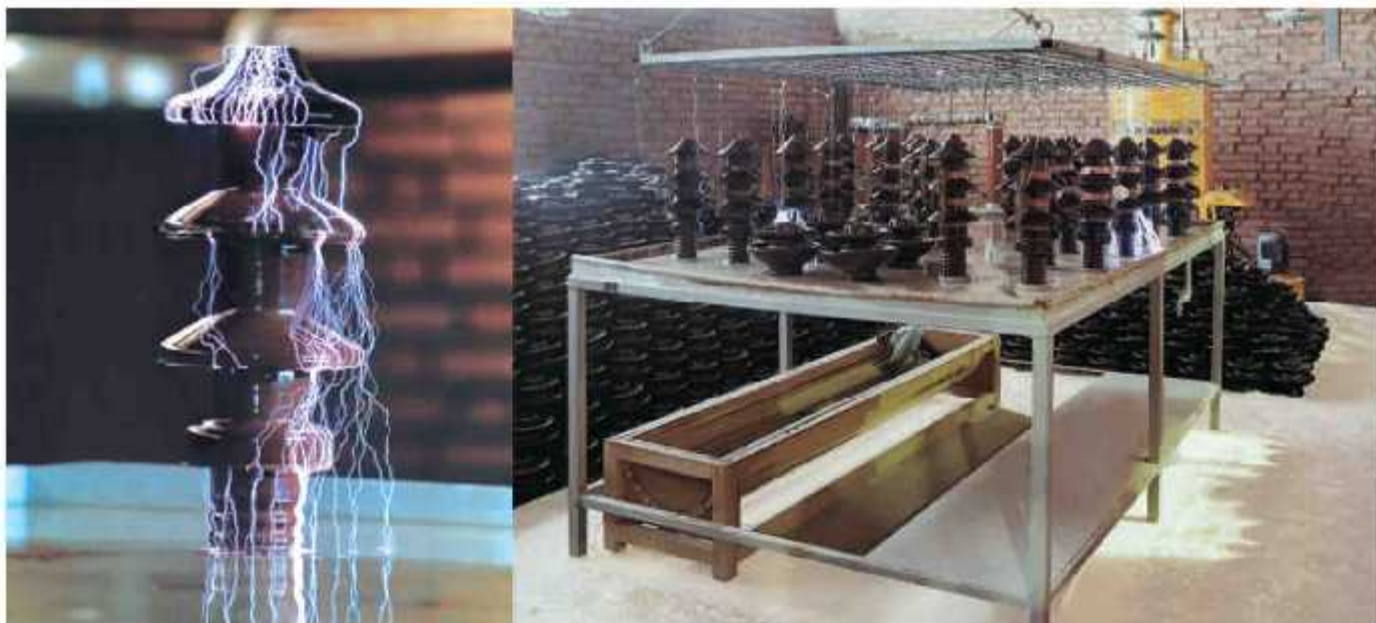

آزمایشگاه فیزیک سرامیک

آزمایشگاه فیزیک - سرامیک بمنظور بهبود و ارتقاء قدرت الکتریکی و مکانیکی مفردها با تجهیزات مدرن تأسیس شده است. آزمایشات فیزیکی، الکتریکی و مکانیکی مانند آزمایش استحکام خمشی، استحکام خمشی خام تست تخلخل باز، شوک حرارتی، استحکام الکتریکی، دانسیته دوغاب، پلانسیته دوغاب و دانه بندی بر روی بدنه مفرد، لعاب و سیمان انجام می شود.

Ceramic physical laboratory

The ceramic-physical laboratory is established for the purpose of improving the mechanical and electrical strength of the insulators with high tech equipment.

Mechanical & electrical tests such as bending strength test, green bending strength, open porosity test, thermal shock, electric strength, slurry density, slurry plasticity and grain sizes are performed on insulator's body, glaze and cement.



Bushing insulator 10 NF 250

Type: Transformer bushing insulator – 10 NF 250

Creepage distance / mm	290
Arcing distance / mm	190
Nominal current / A	250
Lightning impulse withstand voltage / KV	75
Wet power freq. withstand voltage / KV	35
Dry power freq. withstand voltage / KV	65
Average weight of insulator / Kg	3.3

Standard specification: DIN42531, IEC233

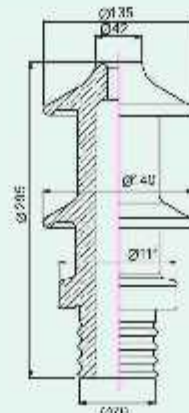

Bushing insulator 20 NF 250

Type: Transformer bushing insulator – 20 NF 250

Creepage distance / mm	445
Arcing distance / mm	270
Nominal current / A	250
Lightning impulse withstand voltage / KV	125
Wet power freq. withstand voltage / KV	55
Dry power freq. withstand voltage / KV	115
Average weight of insulator / Kg	4.8

Standard specification: DIN42531, IEC233

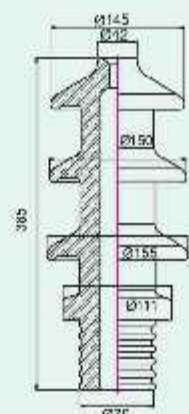

Bushing Insulator 30 NF 250

Type: Transformer bushing insulator – 30 NF 250

Creepage distance / mm	600
Arcing distance / mm	360
Nominal current / A	250
Lightning impulse withstand voltage / KV	170
Wet power freq. withstand voltage / KV	75
Dry power freq. withstand voltage / KV	125
Average weight of insulator / Kg	6.3

Standard specification: DIN42531, IEC233





Bushing insulator 10 NI 250

Type: Transformer bushing insulator – 10 NI 250

Creepage distance / mm	175
Arcing distance / mm	90
Nominal current / A	250
Lightning impulse withstand voltage / KV	75
Wet power freq. withstand voltage / KV	-
Dry power freq. withstand voltage / KV	-
Average weight of insulator / Kg	2.4

Standard specification: DIN42532

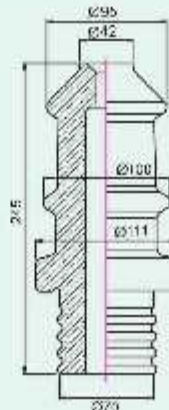

Bushing insulator 10 NF 630

Type: Transformer bushing insulator – 10 NF 630

Creepage distance / mm	330
Arcing distance / mm	190
Nominal current / A	630
Lightning impulse withstand voltage / KV	75
Wet power freq. withstand voltage / KV	35
Dry power freq. withstand voltage / KV	100
Average weight of insulator / Kg	4.3

Standard specification: DIN42532, IEC233, IEC137

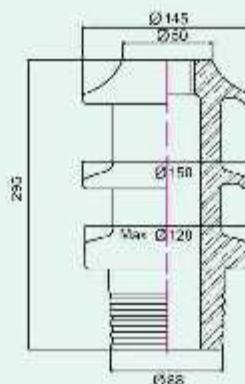

Bushing insulator 20 NF 630

Type: Transformer bushing insulator – 20 NF 630

Creepage distance / mm	445
Arcing distance / mm	270
Nominal current / A	630
Lightning impulse withstand voltage / KV	125
Wet power freq. withstand voltage / KV	75
Dry power freq. withstand voltage / KV	115
Average weight of insulator / Kg	6.3

Standard specification: DIN42532, IEC233, IEC137

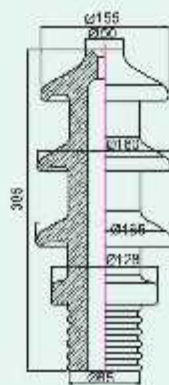

Bushing insulator 30 NF 630

Type: Transformer bushing insulator — 30 NF 630

Creepage distance / mm	635
Arcing distance / mm	360
Nominal current / A	630
Lightning impulse withstand voltage / KV	170
Wet power freq. withstand voltage / KV	70
Dry power freq. withstand voltage / KV	135
Average weight of insulator / Kg	8.5

Standard specification: DIN42532, IEC233, IEC137

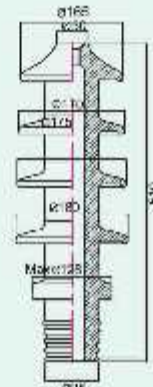

Bushing insulator 10 NF 1000

Type: Transformer bushing insulator — 10 NF 1000

Creepage distance / mm	340
Arcing distance / mm	180
Nominal current / A	1000
Lightning impulse withstand voltage / KV	75
Wet power freq. withstand voltage / KV	35
Dry power freq. withstand voltage / KV	105
Average weight of insulator / Kg	7.3

Standard specification: DIN42532, IEC233, IEC137

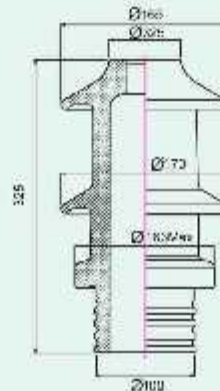

Bushing insulator 20 NF 1000

Type: Transformer bushing insulator — 20 NF 1000

Creepage distance / mm	480
Arcing distance / mm	260
Nominal current / A	1000
Lightning impulse withstand voltage / KV	125
Wet power freq. withstand voltage / KV	55
Dry power freq. withstand voltage / KV	105
Average weight of insulator / Kg	5.6

Standard specification: DIN42533, IEC233, IEC137

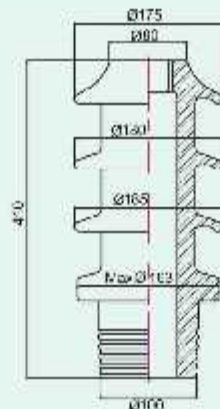



Bushing insulator 30 NF 1000

Type: Transformer bushing insulator – 30 NF 1000

Creepage distance / mm	635
Arcing distance / mm	360
Nominal current / A	1000
Lightning impulse withstand voltage / KV	170
Wet power freq. withstand voltage / KV	70
Dry power freq. withstand voltage / KV	-
Average weight of insulator / Kg	11.4

Standard specification: DIN42533, IEC233, IEC137

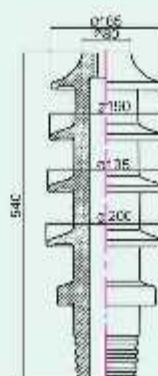

Bushing insulator 10 NF 3150

Type: Transformer bushing insulator – 10 NF 3150

Creepage distance / mm	290
Arcing distance / mm	180
Nominal current / A	3150
Lightning impulse withstand voltage / KV	75
Wet power freq. withstand voltage / KV	28
Dry power freq. withstand voltage / KV	-
Average weight of insulator / Kg	8.3

Standard specification: DIN42533, IEC233, IEC137

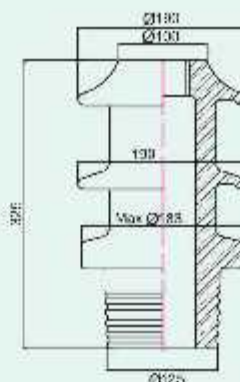

Bushing insulator 20 NF 3150

Type: Transformer bushing insulator – 20 NF 3150

Creepage distance / mm	445
Arcing distance / mm	260
Nominal current / A	3150
Lightning impulse withstand voltage / KV	125
Wet power freq. withstand voltage / KV	50
Dry power freq. withstand voltage / KV	85
Average weight of insulator / Kg	11

Standard specification: DIN42533, IEC233, IEC137

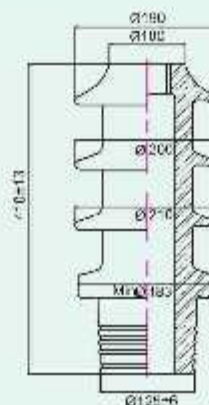



Bushing insulator A,B1-3150

Type: Transformer bushing insulator A1- 3150

Creepage distance / mm	100
Arcing distance / mm	90
Nominal current / A	3150
Wet power freq. withstand voltage / KV	12
Dry power freq. withstand voltage / KV	25
Average weight of insulator / Kg	1.3
Standard specification: DIN42530, IEC233	

TYPE	Nominal Current (A)
B1-3150	3150 (A)

Standard specification: DIN 42530

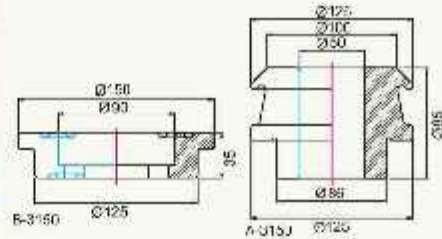

Bushing Insulator A,B1-2000

Type: Transformer bushing insulator A1- 2000

Creepage distance / mm	100
Arcing distance / mm	90
Nominal current / A	2000
Wet power freq. withstand voltage / KV	10
Dry power freq. withstand voltage / KV	25
Average weight of insulator / Kg	0.78
Standard specification: DIN42530, IEC233	

TYPE	Nominal Current (A)
B1-2000	2000 (A)

Standard specification: DIN 42530

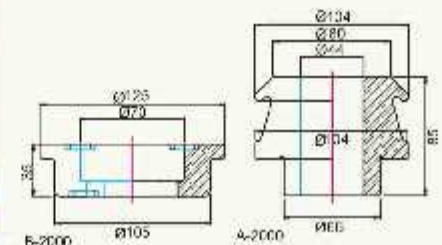

Bushing Insulator A,B1-1000

Type: Transformer bushing insulator A1- 1000

Creepage distance / mm	100
Arcing distance / mm	90
Nominal current / A	1000
Wet power freq. withstand voltage / KV	15
Dry power freq. withstand voltage / KV	25
Average weight of insulator / Kg	0.57
Standard specification: DIN42530, IEC233	

TYPE	Nominal Current (A)
B1-1000	1000 (A)

Standard specification: DIN 42530

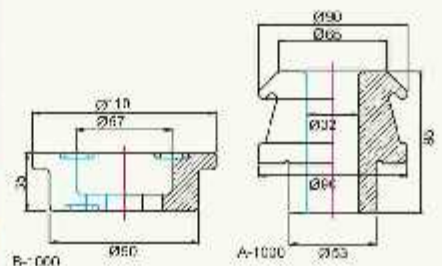



Bushing insulator A,B1-630

Type: Transformer bushing insulator A1- 630

Creepage distance / mm	95
Arcing distance / mm	85
Nominal current / A	630
Wet power freq. withstand voltage / KV	20
Dry power freq. withstand voltage / KV	30
Average weight of insulator / Kg	0.38
Standard specification: DIN42530, IEC233	

TYPE	Nominal Current (A)
B1-630	630 (A)
Standard specification: DIN 42530	

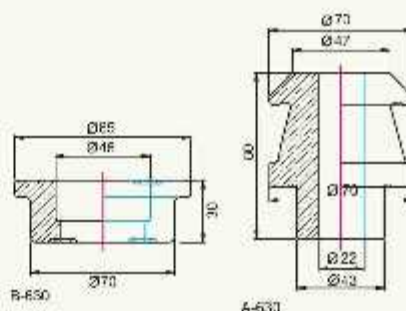

Bushing Insulator A,B1-250

Type: Transformer bushing insulator A1- 250

Creepage distance / mm	80
Arcing distance / mm	73
Nominal current / A	250
Wet power freq. withstand voltage / KV	15
Dry power freq. withstand voltage / KV	20
Average weight of insulator / Kg	0.152
Standard specification: DIN42530, IEC233	

TYPE	Nominal Current (A)
B1-250	250 (A)
Standard specification: DIN 42530	

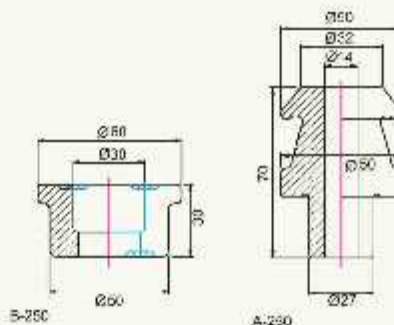

Bushing insulator A,BR3-4500

TYPE	Nominal Current (A)
AR3 - 4500	4500 (A)
Standard specification: DIN 42530	
TYPE	Nominal Current (A)
BR3 - 4500	4500 (A)
Standard specification: DIN 42530	

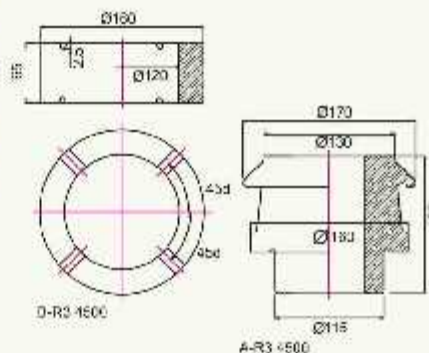

Pin Insulator 20 kV

Technical Data

Creepage distance / mm	432
Power frequency dry Flashover / k Ave.	80
Power frequency wet Flashover / kV Ave.	65
Power frequency puncture voltage / kV	145
Cantilever Strength / KN	13.6
Standard specification: ANSIC 29 - 6	

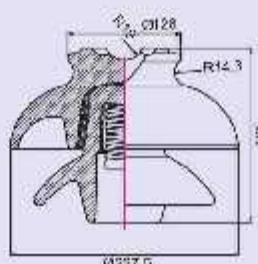

Disk insulator 15000lb

Technical Data

Porcelain disk diameter / mm			254
Unit spacing / mm			146
Creepage distance / mm			292
Electro mechanical failing load / KN			70
Minimum Flashover voltage	Power	Dry / kV	75
	Frequency	Wet / kV	45
	50%Impulse	Positive / kV	120
		Negative / kV	-
Withstand Voltage	Power	Dry / kV	70
	Frequency	Wet / kV	40
	Impulse / kV		110
Power frequency puncture voltage / kV			110
Ball and socket size			16A
Lacking device			R Clip
Standard specification: IEC - 383			

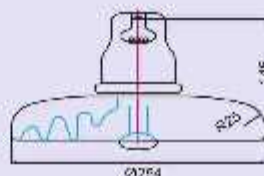



Spool insulator 1

Type: Spool insulator (8)

Creepage distance / mm

-

Power frequency

Wet / kV

12

Dry / kV

25

Transverse strength / kN

13.3

Weight / kg

0.41

Standard specification: ANSI C 29.3 - 1980

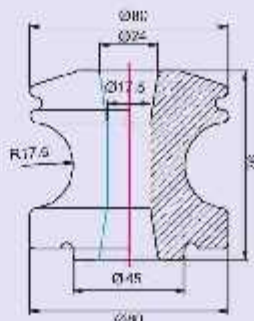

Spool Insulator 2

Type: Spool insulator (8)

Creepage distance / mm

-

Power frequency

Wet / kV

10

Dry / kV

18

Transverse strength / kN

10

Weight / kg

0.41

Standard specification: ANSI C 29.3 - 1980

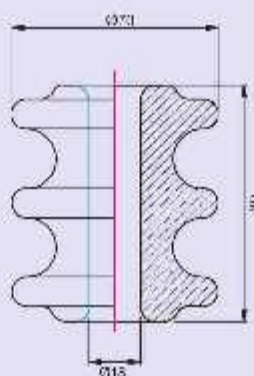



Zanjan Sadaf Gostar Insulator Co.

We look forward to serving the purchasers, nationwide and beyond, constantly through our dedication to quality, firm belief in advancement and our solemn pledge to manufacture the state-of-the art products.

Thus we always endeavor to stay ahead and explore the best.

IRAN TRANSFO CORPORATION

PORCELAIN INSULATORS

- Low, medium and high voltage insulators
- Transformer bushing insulators
- Line insulators
- For outdoor and indoor use



**IRAN TRANSFO
CORPORATION**

www.iran-transfo.com
WE EARN CUSTOMER SATISFACTION

Document No.:
CI0090-Rev0.2005